

Valley Gates

Vista Avenue is a main traffic corridor to the City. As a primary route from the Airport and Interstate 84, the gateway-like aspect of Vista Avenue has long been established. However, before these modes of transportation were present, Vista Neighborhood was the entrance to the City via train. Vista Neighborhood gets to boast one of the finest architectural treasures of the City, the Boise Train Depot. Train Depots were the original gateways into cities and towns. This correlation between corridor, gateway and transportation within Vista Avenue Neighborhood has modern and historical references. The arrangement of steel tubes not only reflect land formations but visually evoke qualities of railroads and trains. As mentioned previously, as one drives past railroad tracks, the ties create a animation like motion that is also present in the sculpture. The front of a train, the rail sweeper or cattle catcher as it is called, is another visual reference that the sculpture eludes to.

My hope is that the sculpture will be appreciated by all viewers for the dynamic presence it exudes, however, Boiseians and Vista Neighborhood residents will find layers of content and historical references like these that are specifically inspired by the Vista Avenue area.

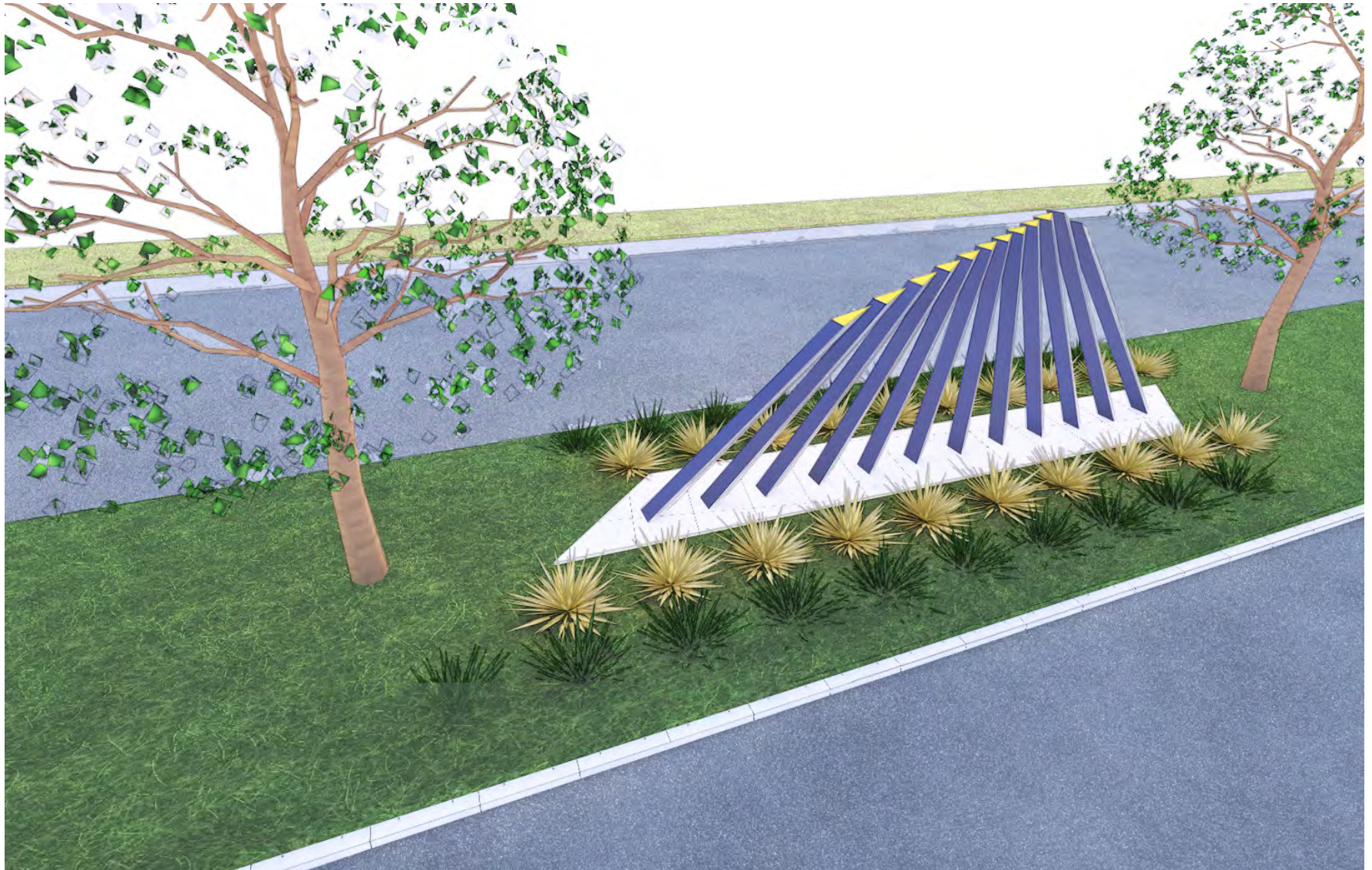



Malad median: South bound

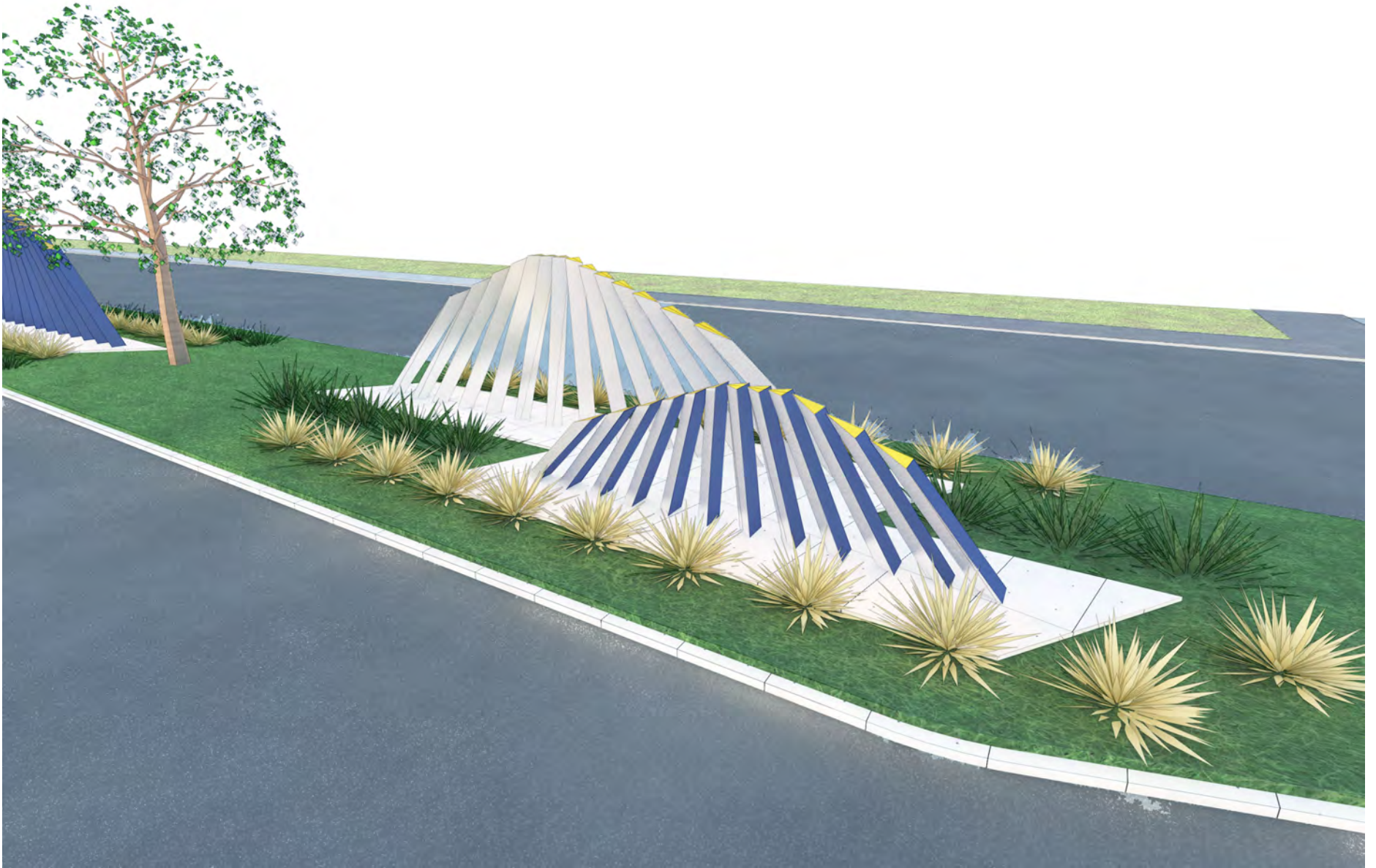

Cherry Lane intersection

Valley Gates

At the "entrance" points of the medians the mountain formations are placed at an angle towards the direction of traffic, allowing for the best possible site line from a moving vehicle. The groupings slowly shift to a parallel placement as they proceed to center. Entering or exiting Vista Avenue from Cherry Lane gives a straight forward view of the foothill formations located there. This vantage point gives pedestrians and nearby business a unique vantage point.

Formation layouts are designed to work with the existing trees. However, the landscaping can be enhanced for a bolder statement that is fitting to a city gateway. The idea is to remove grass at the "tips" of each median and replace with landscaped plantings while the grass remains in the central parts of the medians. Working with the angle placement of the formations, plant layout would follow the same geometry and flow of the sculptures. The intention is to use plants that are low maintenance but have a relevant context to the sculptures. Perennials such as ornamental grasses remain low to the ground and require little to no upkeep. Flowers such as Lupine would relate locally to the foothills and nearby mountains and be of minimal maintenance. The addition of texture and color from plants would compliment the sculptures and create a welcoming statement. I propose to work with the Parks and Rec Department to determine species of plants and flowers that would not significantly impact maintenance. The landscaping aspect to this proposal is recommended but not required although it would enhance the overall aesthetic of the medians.

Valley Gates: Site Plan

North Median

South Median

Targee Street

Cherry Lane

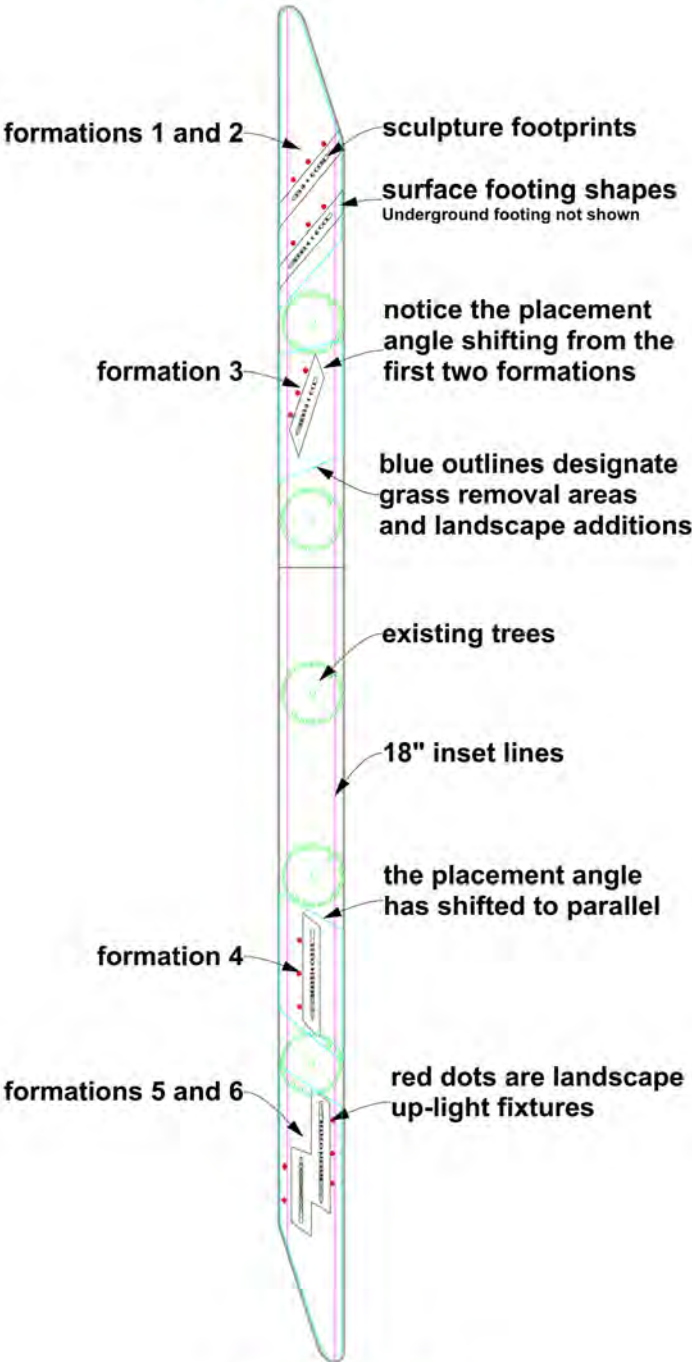

Cherry Lane

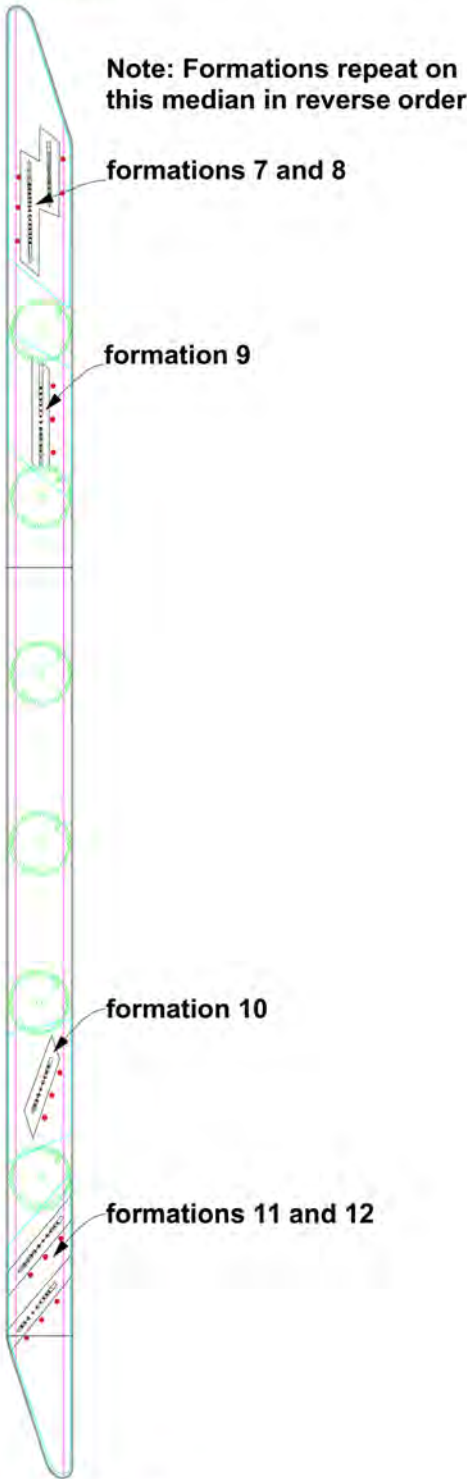

Malad Street

↓
to airport

Valley Gates: Lighting Plan

See Site Plan for fixture locations.

Landscape up-lighting fixtures are proposed for each formation, three fixtures spaced across the dominate viewing side. For example if North bound on Vista then fixtures are placed on the South side of formation as that side is the dominate view for North bound traffic. A total of 36 fixtures are needed to light all formations. Low watt LEDs with a color temperature of 4000K - 5000K, a bright white to blue light color are recommended. Fixtures with adjustable heads should be spec'd for accurate beam placement. The up-lighting will have a dramatic effect on the sculpture creating enhanced views at night.

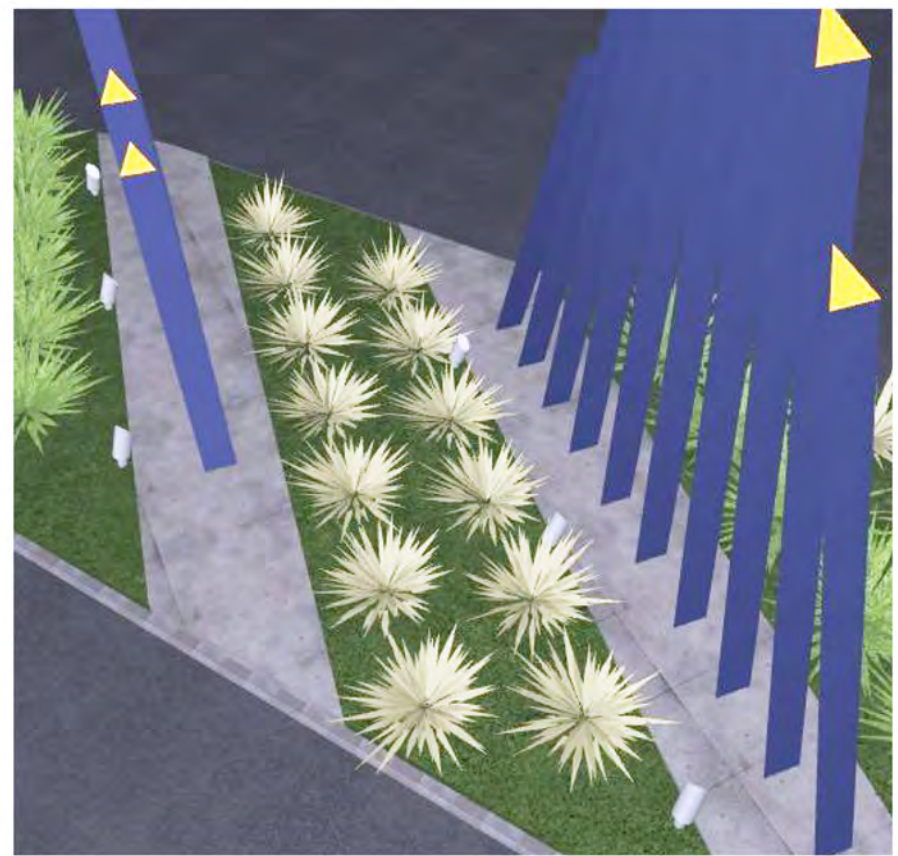

Note: Images still show grass near the sculpture footprints, however, I propose to remove it. Fixtures would be in landscaping, not grass, for ease of maintenance.

Valley Gates: Footing Plans

Note: Footing design to be verified by engineer

Footing Section

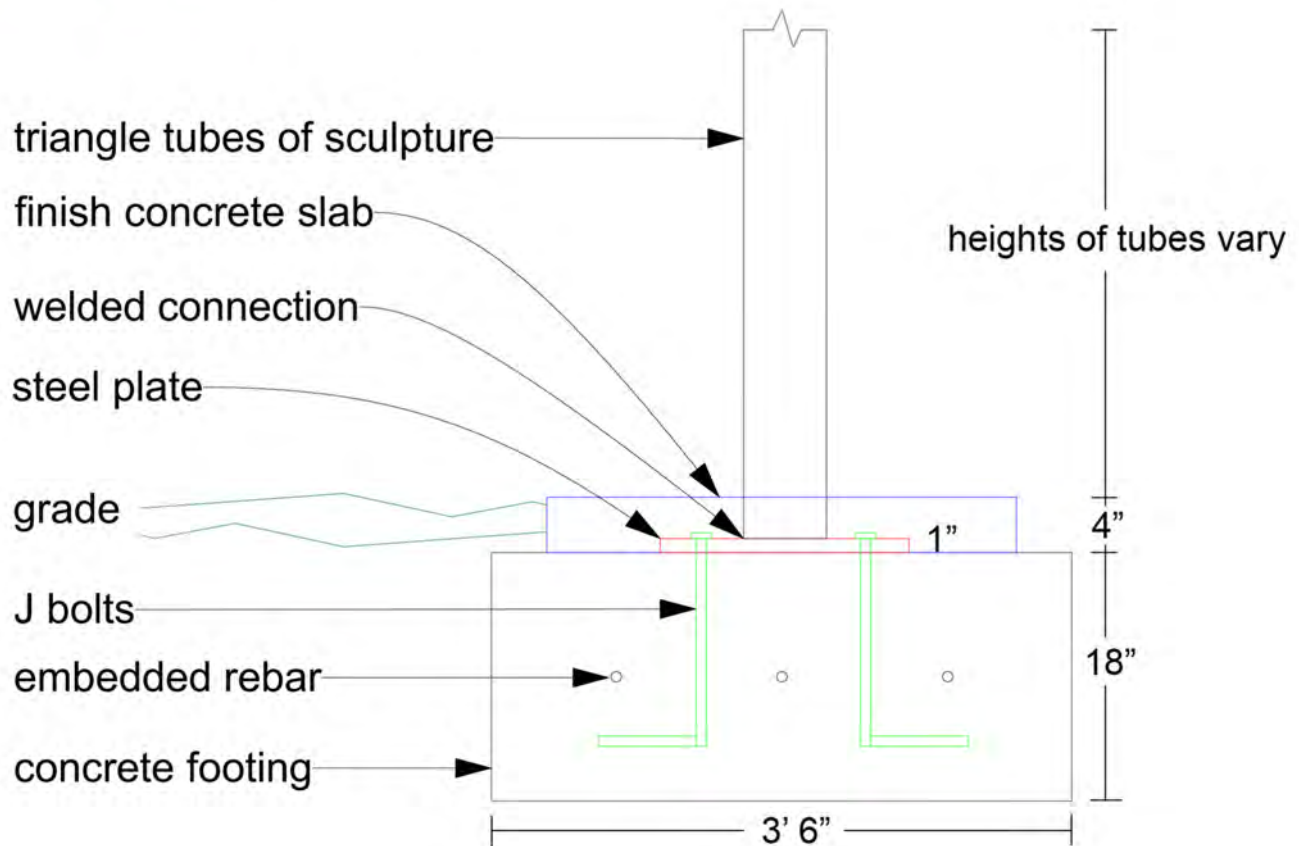

Footing Plan View

Note: This is representative of all 12 footing plans. They are all similar but vary in positioning within the medians and differ in dimensional lengths.

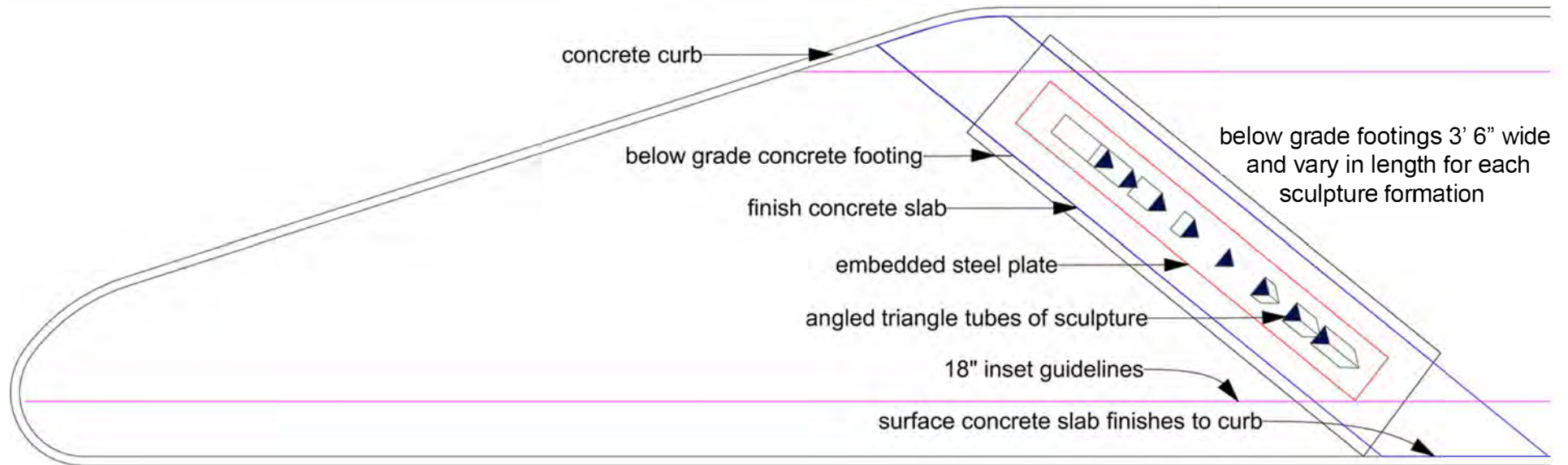

Valley Gates: Artist Statement

250 character limit

I am interested in unearthing the essence of a place through means of history, architecture, site and unique natural phenomenon. Site specificity is of the utmost importance as my aim is a symbiosis between humans and the ephemeral aspects of time and place.

Valley Gates: Vista Avenue Public Art Timeline

Task	Description	Projected Completion
Submit Proposal	Public Review and Selection panel decision	June
Contract Stage	Complete contracts and invoice first payment	July
Complete Design/Working Drawings	Complete detailed working drawings for fabrication	August
Engineering	Receive stamped structural engineering drawings	August
Landscape Planning (if applicable)	Work with Parks and Rec, landscape architect if needed for landscaping plan	September
Order sample materials	to be used for mock up	September
Create partial full scale mock up	Build a full size model using 3 - 4 full length tubes	September/October
Mock up finishing	Send partial mock up to powder coater, create custom color samples	October/November
Finalize fabrication techniques	After reviewing the mock up and samples then a full fabrication plan can be made	November/December
Materials ordered		December/January 2019
Begin Fabrication	Materials arrive, fabrication begins	February thru June 2019
Finishing	Transport to powder coater for finishing	June/July 2019
Final assembly	Finish base plates, receive materials back from finishing, assemble formations	July thru September 2019
Installation Coordination	Create plan for installation with chosen contractor	June/August 2019
Installation	by Public Works Contractor	September/ October 2019
Landscaping (if applicable)	Plantings completed after installation is finalized	September/October 2019
Completion		October 2019

Valley Gates: Vista Avenue Public Art Budget

Item	Description	Quantity	Total
Project Budget			\$147,000.00
Artist Fee		15%	\$22,000.00
Oversight/management		10%	\$14,700.00
Contingency	May be used in part for steel tariffs	10%	\$14,700.00
Materials	Steel triangle tubes, steel base plate		\$43,000.00
Fabrication	Cutting, welding, assembly, machining,		\$32,000.00
Finishing	Powder coating, transportation to and from powder coater		\$17,000.00
Engineering			\$2000.00
Transportation	Transportation to site for installation		\$3600.00
Installation	by Public Works Contractor		0
Total			\$147,000.00